

Entry Types Modules

Quiz

 This article is designated for administrators.

Use the **Quiz** module to enable and [create Kaltura video quizzes](#).

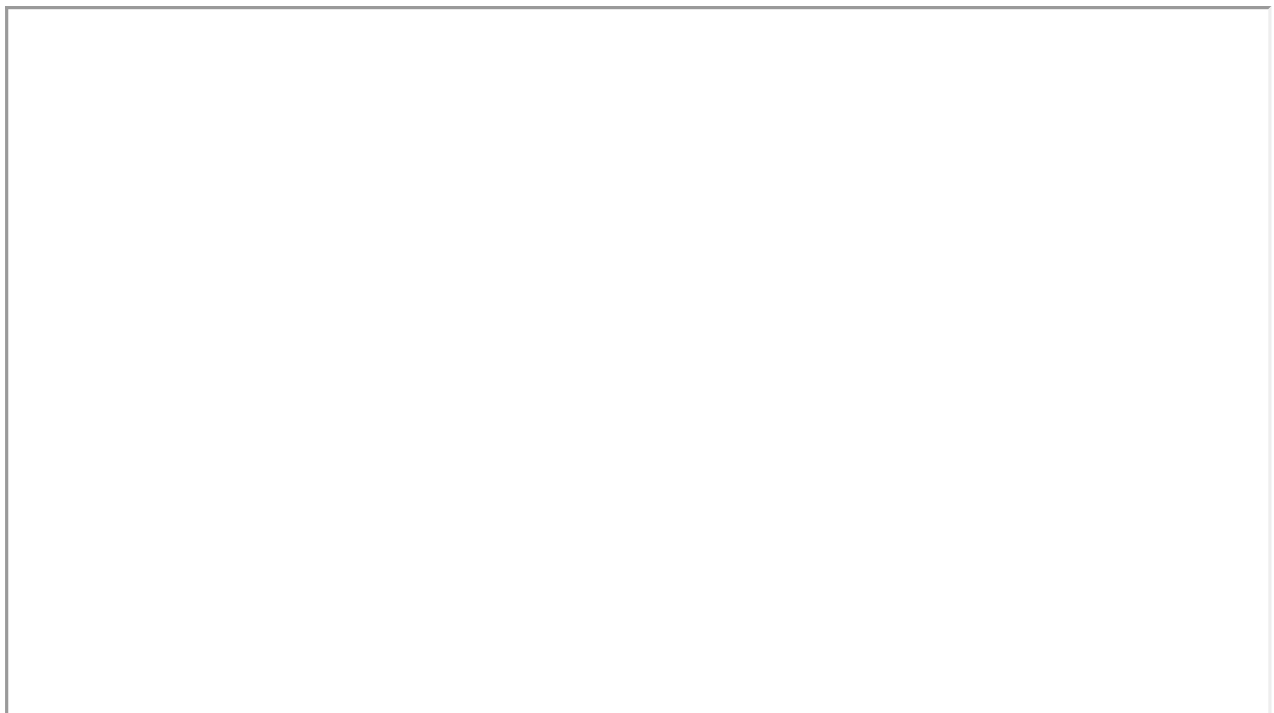

Configure

1. Login to your KMS or KAF admin page, at [https://\[PID.mediaspace\].kaltura.com/admin/](https://[PID.mediaspace].kaltura.com/admin/).
2. In the list of configurable items on the left of your screen, locate and click on **Quiz**.

Modules / entryTypes

Audioentry

Imageentry

Liveentry

Quiz

Webcast

Youtube

The Quiz module window displays.

MANAGE CONFIGURATION	MANAGE USERS	MANAGE GROUPS	KNOWLEDGE BASE	CLEAR THE CACHE	GO TO SITE	LOGOUT
----------------------	--------------	---------------	----------------	-----------------	------------	--------

Configuration Management

Server Tools
 Backup Configuration
 Player replacement tool
Global
 Application
 Auth
 AddNew
 Categories
 Channels
 Client
 Debug
 EmailService
 EmailTemplates
 Gallery
 Header
 Languages
 Login
 Metadata
 Moderation
 My-media
 Navigation
 Player
 Recaptcha
 Security

Quiz

Search Configuration

enabled	Yes	Enable the Quiz module.
quizPlayerId	52243762	The Player ID for the player used for quiz media (*Prevent Seek* feature - Enabled)
playerBarHeightPixels		The height (in pixels) of the player ui which is not part of the actual video (for example - the bottom bar). Leave blank to use the default player value.
playerVideoRatioPercent		The ratio (in percent) of the video inside the player. Standard values: 16:9 = 56.25 , 4:3 = 75 , 16:10 = 62.5. Leave blank to use the default player value.
BSEPlayerId	52243762	The Player ID for the player used in BSE for quiz media (*Prevent Seek* feature - Enabled)
enableQuestionsV2	Yes	Set to Yes to allow quiz creators the use of the new questions types. To use this feature the quiz player should be set to Kaltura version 2.68.3 player or higher.
enableQuestionsV3	Yes	Set to Yes to allow quiz creators the use of the new Open Question type and Retake capabilities. To use this feature, the quiz player version should be 2.75 or higher.
allowedRolesQuiz	admin Role	Who can create a quiz? if a role is selected, any role above it will also be able to create a quiz.
preventForwardSeeks	Enabled	The 'Do not allow seek' feature in the Kaltura Video Editing Tools Editor is enabled. Quiz creators may create a quiz restricting viewers to seek forward in the video. NOTE: Quiz players will be enhanced with the player plugin upon saving of the module.

3. In the **enabled** pull-down, select **Yes**.

4. Enter values for the relevant fields:

- **quizPlayerId** - What is the player ID (uiConf ID) of the player that plays quizzes? The default **playerId** is used if left empty.
- **playerBarHeightPixels** - The height (in pixels) of the player ui which is not part of the actual video (for example - the bottom bar). Leave blank to use the default player value.
- **playerVideoRatioPercent** - The ratio (in percent) of the video inside the player. Standard values: 16:9 = 56.25 , 4:3 = 75 , 16:10 = 62.5. Leave blank to use the default player value.
- **BSEPlayerId** - What is the player ID (uiConf ID) of the player that used to play quizzes in embedded content (BSE Browse Search and Embed)? The Uiconf should have the infoScreen plugin enabled.
- **enableQuestionsV2** - Set to Yes to allow quiz creators the use the new question types. To use this feature the quiz player should be set to Kaltura version 2.68.3 player or higher.
- **enableQuestionsV3** - Set to Yes to allow quiz creators to use Open Question type and Multiple Attempts. To use this feature, the quiz player version should be 2.75 or higher.

 Open questions have a limit of 400 characters for the question and 250 for the answer.

- **allowedRolesQuiz** - Who can create a quiz? if a role is selected, any role above

it will also be able to create a quiz.

- **preventForwardSeeks** - This feature is disabled by default.

NOTE: The **preventForwardSeeks** can't be restored once enabled.

Once enabled, you will not be able to turn off this feature. The 'No seeking forward' setting will be added to the Video Editor, giving the quiz creators the option of whether to restrict viewers from seeking forward in the quiz or not.

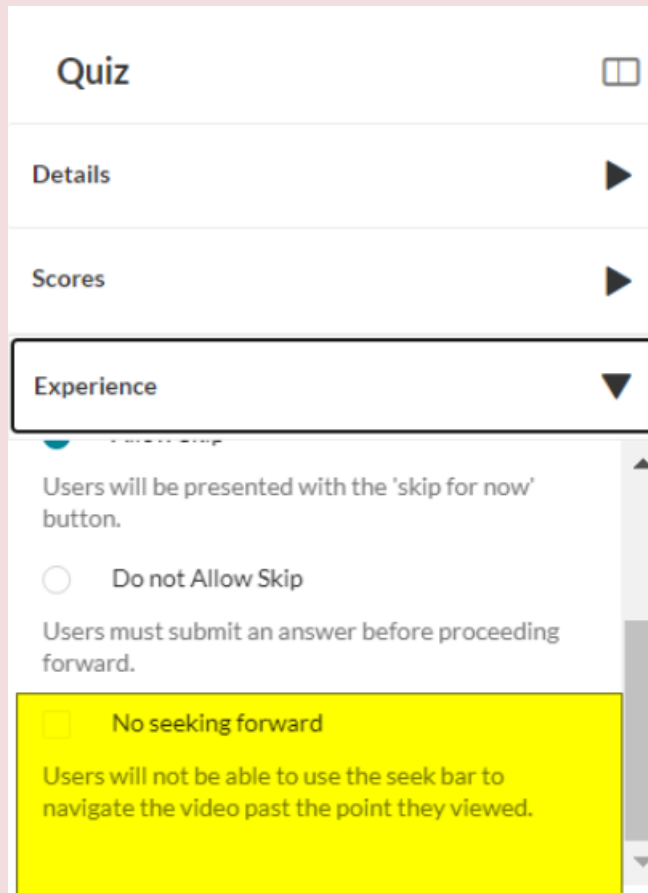

The screenshot shows the 'Quiz' configuration interface. The 'Experience' dropdown menu is open, displaying the following options:

- Users will be presented with the 'skip for now' button.
- ☐ Do not Allow Skip
- Users must submit an answer before proceeding forward.
- ☐ **No seeking forward** (highlighted in yellow)
- Users will not be able to use the seek bar to navigate the video past the point they viewed.

Verify VQ is enabled

1. Login to your KMS or KAF instance.
2. Click **+ Create** to see the list of options for adding media.
Video Quiz is displayed as an option.

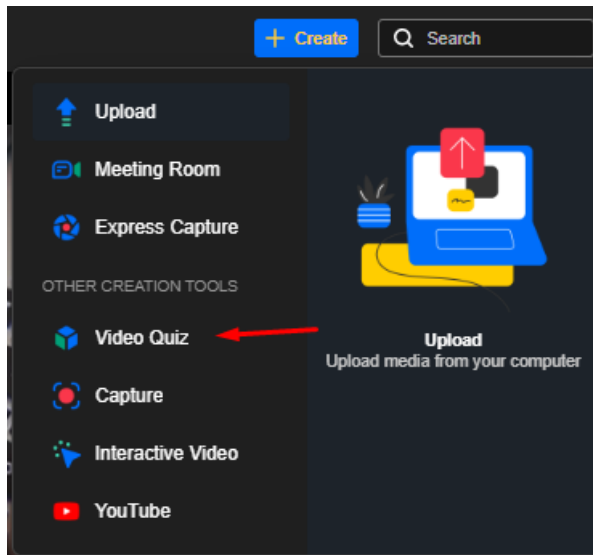

Tips

- ✓ **Video quiz analytics** - Quiz creators can view the quiz analytics and the users that have submitted them. Make sure to enable [Userreports module](#) to view Video Quiz analytics!

- ✓ **The video quiz session time** is set in the sessionLifetime parameter configured globally in the [Auth](#) module on the KMS/KAF admin page. (This is the same session time for any action in Kaltura applications).

sessionLifetime

How long (in seconds) can a MediaSpace user session last? If set value is lower than the minimum of 3600 seconds (1h), the minimum will be utilized.

Related modules

Player

Audioentry

This module allows you to set a dedicated player (different than the default KMS player) for audio entries.

Field	Description
customPlayerId	The player ID (uiConf ID) of the player that plays audios. Leave blank to use the KMS default player.
playerBarHeightPixels	The height (in pixels) of the custom player UI is not part of the actual video (for example - the bottom bar). Leave blank to use the default player value.
playerVideoRatioPercent	The ratio between the width and height (in percent) of the player's asset area. Standard values: 16:9 = 56.25 , 4:3 = 75 , 16:10 = 62.5. Leave blank to use the default player value.
embedSizes	<p>Set the sizes that can be used for embedded players.</p> <p>set the player size in the following format: {width}x{height}. This setting requires a custom player.</p> <p>If a custom player is not specified, the audio entry uses the default video player.</p> <p>To learn about how to embed a media item, please see Share and Embed Media.</p>

Imageentry

This module allows you to set a dedicated player (different than the default KMS player) for image entries.

Field	Description
imageWatermarkUrl	What is the url of the image that should be used as watermark?
customPlayerId	What is the player ID (uiConf ID) of the custom player that shows images? Leave blank to use the default player.
playerBarHeightPixels	The height (in pixels) of the player ui which is not part of the actual video (for example - the bottom bar). Leave blank to use the default player value.
playerVideoRatioPercent	The ratio (in percent) of the video inside the player. Standard values: 16:9 = 56.25 , 4:3 = 75 , 16:10 = 62.5. Leave blank to use the default player value.

Liveentry

Field	Description
enabled	Enable the Liveentry module.
multicastStreaming	Use multicast streaming for Live Events (if DVR is enabled, it will be disabled in runtime).
dvrEnabled	Enable DVR for Live Events
recordingEnabled	Enable recording of Live Events (up to 24 hours)
transcodingProfile	Which transcoding profile will be used for Live Events? Select Cloud or Multicast.
liveBroadcasterRole	Who can create Live Events? If a role is selected, any role above it will also be able to create live events.
allowedUsers	Select users who are allowed to create Live Events.
krecordUIConfId	ID of the UIConf for KRecord used for publishing live streams.

YouTube

Public YouTube video content and metadata can be added to MediaSpace and KAF applications.

 YouTube content can be played on the Kaltura V2 player from version 2.13 and above. To update the player version, refer to [How to Update the Kaltura Player to the Latest Version](#)

Because the video itself still ‘resides’ on YouTube, a YouTube entry is treated differently in some ways from a native Kaltura entry.

- What is supported?
 - Basic and custom metadata

- Sunrise/sunset (scheduled publishing)
- Commenting
- Collaboration (changing owner, adding co-editor and co-publisher)
- Attachments
- ***Uploading a caption file to Kaltura entry / Requesting captions via REACHv2***
- Replace Video (with new YouTube URL)
- Playback analytics
- Video Quiz

- What is not supported?

- Kaltura REACH auto-captioning
- Change Thumbnail
- Enable download
- ***Viewer's ability to enable/disable YouTube captions (these are the captions associated with the YouTube video)***
- Timeline (Chapters and slides)
- Trim/Clip
- Playback rate selector

Field	Description
enabled	Enable the Youtube module
previewPlayer	The player uiconf to use for the YouTube entry preview when adding a new entry. Leave blank to use the default MediaSpace player.
replaceYouTubeEntryMessage	The message to display when replacing a YouTube entry.

 It is best practice to check current availability of a video ingested to Kaltura but hosted on YouTube. A spinning wheel displays for KMS users if the YouTube video has been erased or unpublished from the YouTube platform.

Draftentry

The Draftentrymodule allows users to create an entry in MediaSpace, without uploading actual content (video, audio, or image). The user may specify the metadata of the entry (e.g. title and description) at the time of creation. The use case for this module is that one user creates the entry and enters the metadata. The user can add content at a later time, or the content may be added by a different user.

Field	Description
addMediaFromUrl	Users are always allowed to upload media from their desktop; this configuration adds another way to upload media. Select Yes to allow users to import media from a URL (YouTube for example). If set to No, users will not have the option of importing media from a URL and will only be allowed to upload media from their desktop.
validateUrl	Select Yes to have the system validate the URL that a user enters. If set to No, the system will not validate URLs. If a user types an invalid URL, the content will not be uploaded and they must re-enter a URL.
draftEntryMode	<p>Select Video Draft Entry (recommended) to make the draft entry that can receive only video content (no audio/image). Such draft entries are fully supported by REACH workflow, and they will be visible in the Kaltura Management Console.</p> <p>Select Base Draft Entry to allow upload any kind of content later. However, such draft entries have a set of known limitations:</p> <ul style="list-style-type: none"> • They are not supported by REACH workflow. Captions for such entries could be requested only after uploading the content. Please do not use Base Draft Entries if you have automatic caption requests configured in your account. • They are not visible in the Kaltura Management Console until uploading the content

Documententry

 This article is designated for administrators.

Uploading a document entry serves various purposes, such as providing event details, instructions, or supplementary materials to enrich the hosted media. Media owners can upload and view documents in formats like pdf, doc, docx, ppt, pptx, xls, xlsx, csv, and txt.

 You must have the [Theming module](#) with the **mediapage** feature enabled when using the document entry feature.

1. Go to your KMS or KAF admin page, and navigate to the Documententry module. Your link should look like this:
https://{your_KMS_URL}/admin/config/tab/documententry.

Modules / entryTypes

Audioentry
Documententry
Draftentry
Imageentry
Liveentry
Quiz
Youtube

The Documententry window opens.

Documententry

Search

Module Info

description

Enabling this module will allow users to upload and view documents of the following types: pdf, doc, docx, ppt, pptx, xls, xlsx, csv, txt

Note

Depends on the [Theming module](#).

enabled

Yes ▼

Enable the Documententry module.

DocDownload

Yes ▼

Documents download is enabled by default to all newly uploaded documents, however media owners can disable download for each specific document from the edit media page. Once "Disabled" is selected, all downloading of documents is disabled regardless of media owners decision.

Save

2. Configure the following:

enabled - Set to 'Yes'.

DocDownload - Set to 'Yes' if you want users to download the documents.

⚠ By default, downloading is enabled for all documents, and media owners can disable download for individual documents from the 'edit media' page. Once '**DocDownload**' is disabled, document downloading is universally disabled. However, it's important to note that even if the administrator has removed the download button, a user can always download a document from the [viewing application](#) as this is outside Kaltura's control.

The image below shows a PowerPoint document with downloading enabled.



Same document with downloading disabled.

MediaSpace
Art
Interiors
Open Gallery
Storytelling
Explore Channels
Shop
+ Create
Search
EN





Participate in a Virtual Classroom experience

Quick user guide for participants

SLIDE 1 OF 16

Participate in a Virtual Classroom experience
By Louise Szmoisz • October 22, 2023

0
Share

[template("cat-subscribe")]